

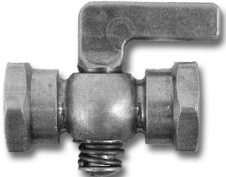

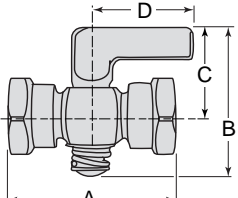

# Eclipse Manual Shut-Off Gas Valves

	<p style="text-align: center;"><b>Lever Handle Valve</b></p> <p style="text-align: center;">Maximum Working Pressure: 5 psig</p> <table border="1" data-bbox="500 625 1180 688"> <thead> <tr> <th>Size</th> <th>Part#</th> <th>A</th> <th>B</th> <th>C</th> <th>D</th> </tr> </thead> <tbody> <tr> <td>1/8"</td> <td>11020</td> <td>1-9/16"</td> <td>1-3/8"</td> <td>7/8"</td> <td>1"</td> </tr> </tbody> </table>	Size	Part#	A	B	C	D	1/8"	11020	1-9/16"	1-3/8"	7/8"	1"																																																													
Size	Part#	A	B	C	D																																																																					
1/8"	11020	1-9/16"	1-3/8"	7/8"	1"																																																																					
	<p style="text-align: center;"><b>Brass Ball Valves</b></p> <p style="text-align: center;">UL, CSA, FM  1/4" - 3/4": 600 psig  1" - 2": 500 psig  2 1/2" - 4": 400psig</p> <table border="1" data-bbox="500 961 1180 1329"> <thead> <tr> <th>Size</th> <th>Part#</th> <th>A</th> <th>B</th> <th>C</th> <th>C<sub>v</sub></th> </tr> </thead> <tbody> <tr><td>1/4"</td><td>10328</td><td>1-7/8"</td><td>1-7/16"</td><td>3"</td><td>12</td></tr> <tr><td>3/8"</td><td>10324</td><td>1-7/8"</td><td>1-7/16"</td><td>3"</td><td>12</td></tr> <tr><td>1/2"</td><td>10334</td><td>2-7/16"</td><td>1-1/2"</td><td>3"</td><td>20</td></tr> <tr><td>3/4"</td><td>10344</td><td>2-3/4"</td><td>1-7/8"</td><td>3-3/4"</td><td>42</td></tr> <tr><td>1"</td><td>10348</td><td>3-5/16"</td><td>2-3/8"</td><td>4-3/4"</td><td>78</td></tr> <tr><td>1-1/4"</td><td>10354</td><td>3-7/8"</td><td>2-5/8"</td><td>4-3/4"</td><td>132</td></tr> <tr><td>1-1/2"</td><td>10357</td><td>4-3/4"</td><td>3-1/4"</td><td>6"</td><td>207</td></tr> <tr><td>2"</td><td>10372</td><td>5"</td><td>3-1/2"</td><td>6"</td><td>346</td></tr> <tr><td>2-1/2"</td><td>14180</td><td>6-1/16"</td><td>4-1/2"</td><td>7-7/8"</td><td>484</td></tr> <tr><td>3"</td><td>14558</td><td>7-1/16"</td><td>5"</td><td>7-7/8"</td><td>639</td></tr> <tr><td>4"</td><td>14559</td><td>8-7/8"</td><td>6"</td><td>9-7/8"</td><td>1092</td></tr> </tbody> </table>	Size	Part#	A	B	C	C <sub>v</sub>	1/4"	10328	1-7/8"	1-7/16"	3"	12	3/8"	10324	1-7/8"	1-7/16"	3"	12	1/2"	10334	2-7/16"	1-1/2"	3"	20	3/4"	10344	2-3/4"	1-7/8"	3-3/4"	42	1"	10348	3-5/16"	2-3/8"	4-3/4"	78	1-1/4"	10354	3-7/8"	2-5/8"	4-3/4"	132	1-1/2"	10357	4-3/4"	3-1/4"	6"	207	2"	10372	5"	3-1/2"	6"	346	2-1/2"	14180	6-1/16"	4-1/2"	7-7/8"	484	3"	14558	7-1/16"	5"	7-7/8"	639	4"	14559	8-7/8"	6"	9-7/8"	1092	
Size	Part#	A	B	C	C <sub>v</sub>																																																																					
1/4"	10328	1-7/8"	1-7/16"	3"	12																																																																					
3/8"	10324	1-7/8"	1-7/16"	3"	12																																																																					
1/2"	10334	2-7/16"	1-1/2"	3"	20																																																																					
3/4"	10344	2-3/4"	1-7/8"	3-3/4"	42																																																																					
1"	10348	3-5/16"	2-3/8"	4-3/4"	78																																																																					
1-1/4"	10354	3-7/8"	2-5/8"	4-3/4"	132																																																																					
1-1/2"	10357	4-3/4"	3-1/4"	6"	207																																																																					
2"	10372	5"	3-1/2"	6"	346																																																																					
2-1/2"	14180	6-1/16"	4-1/2"	7-7/8"	484																																																																					
3"	14558	7-1/16"	5"	7-7/8"	639																																																																					
4"	14559	8-7/8"	6"	9-7/8"	1092																																																																					
	<p style="text-align: center;"><b>Brass Ball Valves with Side Tap</b></p> <p style="text-align: center;">UL, CSA, FM  1/2" - 3/4": 600 psig  1" - 2": 500 psig</p> <table border="1" data-bbox="500 1539 1180 1749"> <thead> <tr> <th>Size</th> <th>Part#</th> <th>A</th> <th>B</th> <th>C</th> <th>D</th> <th>C<sub>v</sub></th> </tr> </thead> <tbody> <tr><td>1/2"</td><td>14969</td><td>2-7/16"</td><td>1-1/2"</td><td>3"</td><td>1/8"</td><td>20</td></tr> <tr><td>3/4"</td><td>12961</td><td>2-3/4"</td><td>1-7/8"</td><td>3-3/4"</td><td>1/8"</td><td>42</td></tr> <tr><td>1"</td><td>19122</td><td>3-5/16"</td><td>2-3/8"</td><td>4-3/4"</td><td>1/8"</td><td>78</td></tr> <tr><td>1-1/4"</td><td>14916</td><td>3-7/8"</td><td>2-5/8"</td><td>4-3/4"</td><td>1/4"</td><td>132</td></tr> <tr><td>1-1/2"</td><td>14918</td><td>4-3/4"</td><td>3-1/4"</td><td>6"</td><td>1/4"</td><td>207</td></tr> <tr><td>2"</td><td>14926</td><td>5"</td><td>3-1/2"</td><td>6"</td><td>1/4"</td><td>346</td></tr> </tbody> </table>	Size	Part#	A	B	C	D	C <sub>v</sub>	1/2"	14969	2-7/16"	1-1/2"	3"	1/8"	20	3/4"	12961	2-3/4"	1-7/8"	3-3/4"	1/8"	42	1"	19122	3-5/16"	2-3/8"	4-3/4"	1/8"	78	1-1/4"	14916	3-7/8"	2-5/8"	4-3/4"	1/4"	132	1-1/2"	14918	4-3/4"	3-1/4"	6"	1/4"	207	2"	14926	5"	3-1/2"	6"	1/4"	346																								
Size	Part#	A	B	C	D	C <sub>v</sub>																																																																				
1/2"	14969	2-7/16"	1-1/2"	3"	1/8"	20																																																																				
3/4"	12961	2-3/4"	1-7/8"	3-3/4"	1/8"	42																																																																				
1"	19122	3-5/16"	2-3/8"	4-3/4"	1/8"	78																																																																				
1-1/4"	14916	3-7/8"	2-5/8"	4-3/4"	1/4"	132																																																																				
1-1/2"	14918	4-3/4"	3-1/4"	6"	1/4"	207																																																																				
2"	14926	5"	3-1/2"	6"	1/4"	346																																																																				

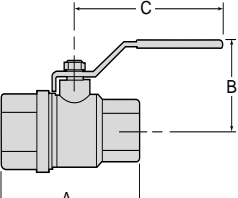

### FM Approved Supervisory Gas Valves

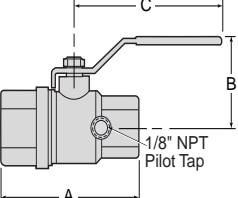
Maximum Working Pressure: 200 psig

Size	Part#	A	B	C	D	C <sub>v</sub>
1/2"	17379	3-3/4"	5-1/4"	2-7/8"	8-1/8"	19
3/4"	15953	3-3/4"	5-1/4"	2-7/8"	8-1/8"	31
1"	15955	4-1/4"	5-5/8"	3-5/16"	9-5/8"	48
1-1/4"	15959	5"	7-1/8"	4"	9-5/8"	92
1-1/2"	15961	5"	7-1/8"	4"	9-5/8"	130
2"	17224	6"	9"	5-1/8"	14-3/4"	220

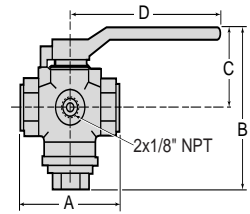

### Lubricated Plug Valves

UL: 200 psig  
 CSA: 125 psig  
 FM (1/2"-3/4" only): 50 psig  
 Wrench supplied Loose

Size	Part#	A	B	C	C <sub>v</sub>
1/2"	18812	3-3/4"	5-1/4"	2-7/8"	19
3/4"	18813	3-3/4"	5-1/4"	2-7/8"	31
1"	18814	4-1/4"	5-5/8"	3-5/16"	42
1-1/4"	18815	5"	7-1/8"	4"	72
1-1/2"	18816	5"	7-1/8"	4"	85
2"	18817	6"	9"	5-1/8"	150
2-1/2"	18818	6-3/4"	9-9/16"	5-3/8"	220
3"	18819	7-5/8"	11-7/16"	6-1/2"	345
4"	18820	10"	13-3/4"	7-3/4"	525

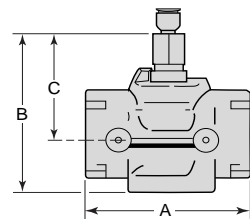

### Eccentric Plug Cocks

(UL Listed & CSA Approved)  
 Maximum Working Pressure: 175 psig

Size	Part#	A	B	C	D	C <sub>v</sub>
1/2"	19790	3-1/4"	4-3/4"	3-1/2"	4"	9
3/4"	19791	3-3/4"	5"	3-5/8"	4"	22
1"	19792	4-1/4"	5-11/16"	4"	5"	35
1-1/4"	19793	4-3/4"	6-1/8"	4-1/4"	5"	54
1-1/2"	19794	5"	6-3/8"	4-3/8"	6"	78
2"	19795	5-1/2"	7"	4-3/4"	6"	135
2-1/2"	19796	6-7/8"	8-3/8"	5-1/2"	8"	180
3"	19797	7-1/2"	9"	5-3/4"	10"	270
4"	19798	9-1/4"	11-1/8"	6-7/8"	12"	500

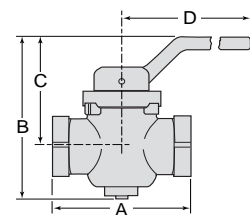



### **Brass Hose Valve**

1/8" NPT male x 1/8" NPT female  
Part# 10322  
CGA certified: 1/2 psig

### **Hose Fitting for Hose Valve**

1/8" NPT male x 1/4" hose  
Part# 14380