

# HPR10

First Stage L.P. Gas Regulator  
Inlet Pressure 21 bar  
Nominal Diameter 1"



**This product is discontinued!**

## Applications

- Industrial
- Commercial

## Brief information

**Operation:** Tight lock-up is ensured by the toggle joint action which applies maximum power as the valve approaches closed position. The toggle mechanism is ruggedly constructed for high pressure service with double diaphragm-stem links and connecting links. The HPR10 is equipped with a diaphragm stem guide, which serves to isolate the diaphragm from the expanding pressure in the regulator body.

The long, straight coil, compression spring provides accurate regulation and is easy to adjust. It may be readily replaced by removing the upper diaphragm chamber.

**Application:** The HPR10 is for pressure reducing applications and has a large diaphragm for accurate regulation of outlet pressure.

**Control:** A comprehensive range of springs is available, as described overleaf. The outlet pressure can be easily and accurately adjusted by turning the spring adjusting screw.

**Technical Data:**

|                          |                     |
|--------------------------|---------------------|
| Maximum inlet pressure:  | 21 bar (305 psig)   |
| Maximum outlet pressure: | 2.8 bar (40.6 psig) |

**Servicing:** The HPR10 has been designed for ease of access, inspection and servicing of all internal components. A standard soft spares kit is available.

Reference number SKHPR10-01

## Main features

- Size 1"
- Temperature range  
-20°C to +80°C
- Threaded connections to BS EN 10226 (ISO 7) or NPT (other threads may be available upon request).
- Internal impulse
- Spring loaded
- Orifice 3/8" size

# HPR10: First Stage LPG Regulator

## Dimensions and Weights

| A   | B   | C  | D  | E   | Weight (Kg) |
|-----|-----|----|----|-----|-------------|
| 178 | 308 | 38 | 95 | 159 | 7.3         |

## Capacities

| Inlet Pressure (bar) | Outlet Pressure (bar) | Capacity (scmh) |
|----------------------|-----------------------|-----------------|
| 0.69                 | 0.35                  | 43              |
|                      | 0.35                  | 119             |
|                      | 1.00                  | 119             |
| 2.8                  | 2.00                  | 92              |
|                      | 0.35                  | 252             |
|                      | 1.00                  | 252             |
| 6.9                  | 2.00                  | 252             |

Above capacities quoted, SCMH

Propane SG = 1.52 1.0 Bar A

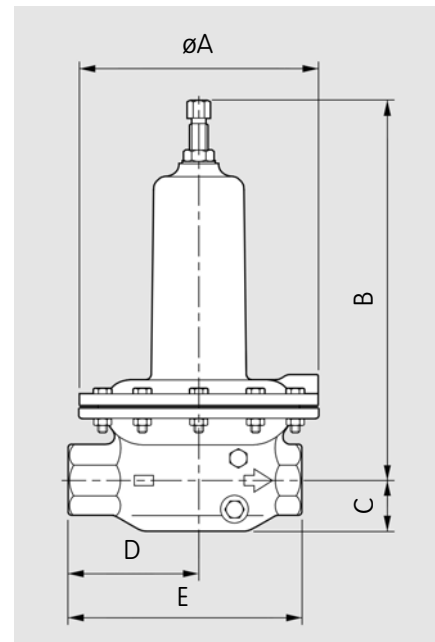

## Material Specifications

A summary of materials used for the HPR10 is given for reference. All material has been selected to provide maximum durability and reliability in service.

| Components      | Specification                     |
|-----------------|-----------------------------------|
| Body and cover  | S.G. Iron                         |
| Main diaphragm  | Nylon reinforced Nitrile (Buna N) |
| Seat disc       | Nitrile (Buna N)                  |
| Orifice         | Brass                             |
| Springs         | Carbon Steel                      |
| Reset Mechanism | Brass with integral nitrile seal  |

## Loading Springs

All springs are colour coded for ease of identification.

| Spring Range |             | Part Number | Colour Code    |
|--------------|-------------|-------------|----------------|
| bar          | PSIG        |             |                |
| 0.17 - 0.34  | 2.5 - 5.0   | I071421P009 | Red - Black    |
| 0.34 - 1.0   | 5.0 - 14.5  | I071421P011 | Green - Black  |
| 1.0 - 1.7    | 14.5 - 24.7 | I071421P012 | Yellow - Black |
| 1.0 - 2.8    | 14.5 - 40.6 | I071421P014 | Blue - Black   |

## Quality:

Elster Jeavons is committed to a programme of continuous quality enhancement. All equipment designed and manufactured by the Elster-Instromet group benefits from the group's quality assurance standards which are approved to EN ISO9001:2008.

## Contacts

United Kingdom  
Elster-Instromet  
4 Pate Road, Melton Mowbray  
Leicestershire LE13 0RG  
T +44 1664 567797  
F +44 1664 410254  
www.elster-instromet.com  
info.jeavons@gb.elster.com

Germany  
Elster GmbH  
Steinern Str. 19 - 21  
55252 Mainz-Kastel  
T +49 6134 605 0  
F +49 6134 605 223  
www.elster-instromet.com  
info@elster.com

USA  
Elster American Meter  
2221 Industrial Road  
Nebraska City, NE 68410-6889  
T +1 402 873 8200  
F +1 402 873 7616  
www.elster-meterservices.com

HPR101EN02

A19.02.2009