

ECLIPSE T500 ROTARY ACTUATOR

The easy, reliable way to optimize burner and valve control while simplifying set-up and maintenance

The Eclipse T500 Series Rotary Actuator is an exceptional control for industrial burners, valves and dampers. Typically, it is used with an electronic controller to provide precise control of a butterfly valve to adjust flow to the burner. Two models are available.

Model T510 Basic, to be driven by:

- a single relay contact for 2-position control
- dual relays for 3-position step, 3PS, 3-point step or bumping control

Model T520 Electronic, to be driven by:

- 4-20mA analog signal
- 2-10VDC analog signal
- 135 ohm potentiometer

Ready for the World

The T500 is ready to install anywhere in the world. It meets applicable U.S.A., Canadian and European standards and is supported by Eclipse around the globe.

Precise and Robust

T500 is engineered for applications requiring a high degree of modulating precision and repeatability. This high level of accuracy enhances the performance of the burner. The quality construction provides reliable operation and delivers higher torque than competitors. T500 is IP65 / NEMA 4 out of the box and it can be installed in outdoor applications.

Easy Installation

T500 can be mounted in any position. A selection of mounting brackets and shafts provides installation flexibility and easy retrofits. In all applications, start-up is simplified. The shaft and cam disengagement clutch allows for the quick



manual alignment of the actuator shaft and switch cams.

Advanced Features

T500 provides up to six internal, easily adjustable switches and a selection of models for a variety of functions. In burner applications requiring high turn-down and reliable ignition, the auxiliary switches can be applied to create separate positions for burner ignition and low fire. In dual fuel applications, additional switches can be used to create separate high fire, low fire or ignition positions for each fuel.

T500 Rotary Actuator

For burner and valve control systems

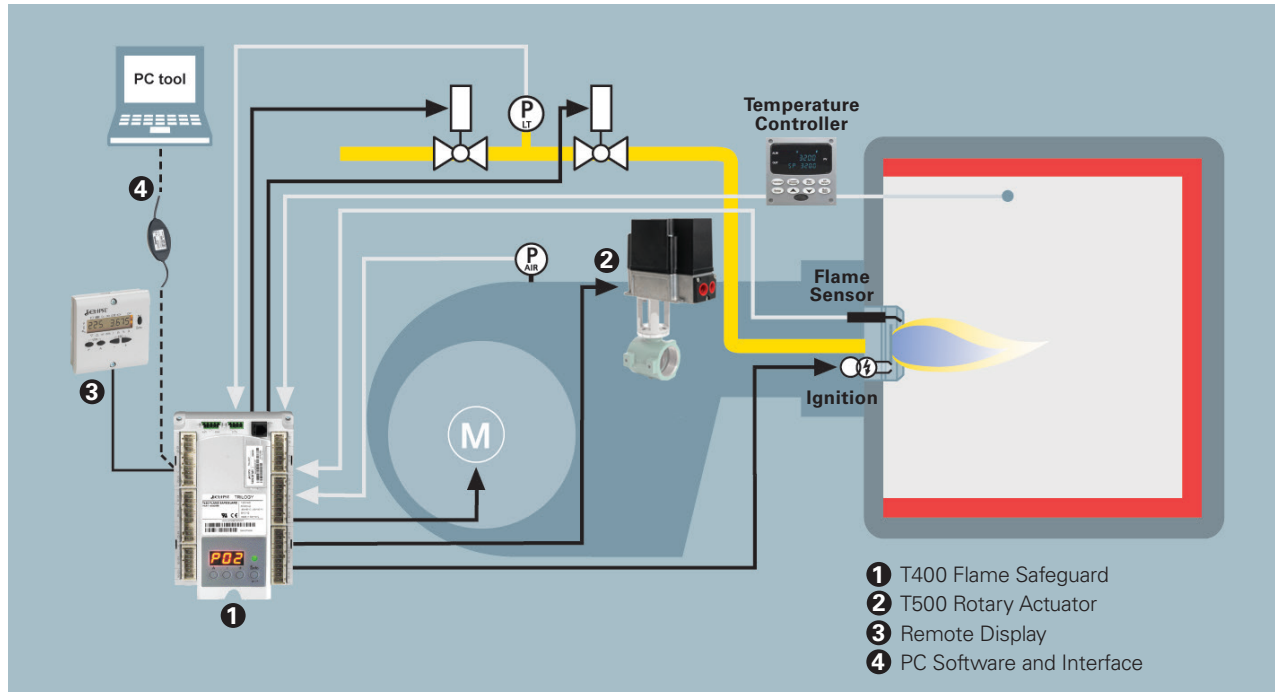

Typical modulating gas burner control system with a T500 Series Rotary Actuator

Trilogy Series Options



T400 Flame Safeguard

Eclipse recommends combining the T500 Series Actuator with the T400 Series Flame Safeguard for a perfectly integrated control solution. The T500 and T400 are designed to work in unison to deliver even more benefits when they are installed together. Choosing this globally approved package will provide you with easy ordering, lower installation costs, simplified start-up and precise burner control.